

## MAIN PARTICULARS

- Length overall:	6.28m
- Beam:	2.28m
- Height:	1.30m
- Design draught:	0.35m
- Scantling draught:	0.40m
- Displacement:	1850kg
- Max. power:	1x 300hp
- Max. speed:	+35kn
- Design Category:	Zona 3   Cat. C
- Passengers:	12pax
- Fuel tank:	1x 160l

# C2 | NAVAL ARCHITECTURE MARINE ENGINEERING

c/ Averroes 4, 28224 Pozuelo de Alarcón | Spain  
T: (+34) 912-877-790 | M: (+34) 655-638-630  
W: www.c2-na.com | E: info@c2-na.com

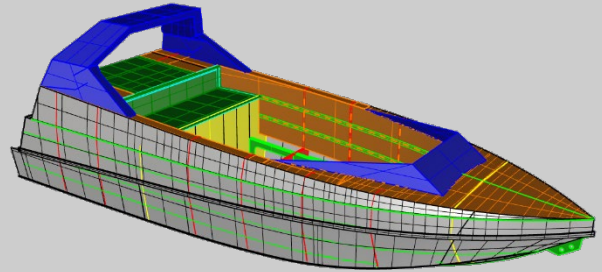

C2 | 059 – JET BOAT MODIFICACIÓN

The JET BOATA is a very fun boat, designed expressly for drifting on the sea.

Equipped with a water jet propulsion allows high performance and sharp turns with the boat in full load condition.

The boat is designed and built in H111 aluminum to withstand the loads of wave impacts at high speed.

This particular boat has 12 individual seats and protection bars to prevent injuries to passengers during the drifts. The skipper seat is positioned completely forward on the starboard side to guarantee a correct view of the navigation.

The fuel capacity is minimized as much as possible to increase the capacity of people on board. The boat is equipped by one fuel tank of 160 liters capacity which offers a range of above 4h at full speed regime.

The boat has a STEYR 306 J38-292HP central engine at 3800rpm in combination with a HAMILTON 213 jet, which allows speeds greater than 35kn.

The boat's structure is designed to withstand the loads originated from "full ahead" to "full astern", also complying with the strictest applicable regulations.

The bilge system is equipped with several automatic pumps in order to guarantee a rapid evacuation of the water embarked during navigation.

The resulting vessel can be high customized and the construction design allows a very short construction time.

Designed to be built in SHARKSILVER ALUMINIUM BOATS shipyard. This boat has become a reference on the coast of Colombia and Spain where there are several units sailing and drifting on its waters.

Built in naval aluminum and equipped with central motorization and HAMILTON jet, this unit is capable of sailing at high speeds and making sharp turns while is partially submerged underwater, maintaining a positive buoyancy at all times.



# C2 | NAVAL ARCHITECTURE MARINE ENGINEERING

The JET BOAT has a low draft and minimal deadrise to facilitate planning at any speed regime.

It is a robust boat with excellent maneuverability thanks to the propulsion system properly designed in collaboration with HAMILTON.

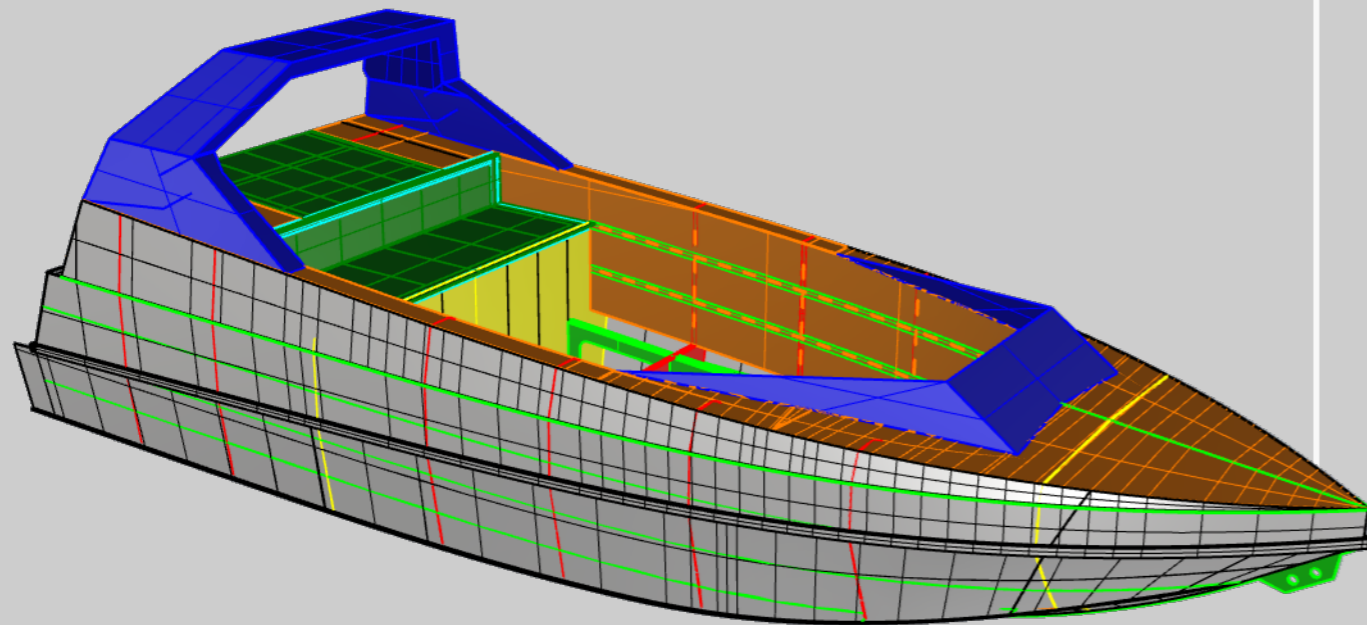

## MAIN PARTICULARS

Length overall:	6.28m
Beam:	2.28m
Height:	1.30m
Design draught:	0.35m
Scantling draught:	0.40m
Design Category (CE):	Zona 3   Cat. C
Max. power:	1x 300hp
Max. speed:	+35kn
Passengers:	12pax
Fuel tank:	1x 160l

C2-059 | JET BOAT MODIFICACIÓN