

MAIN PARTICULARS

- Length overall:	13.50m
- Length between perpendiculars:	11.90m
- Beam:	5.50m
- Height:	4.20m
- Design draught:	0.75m
- Scantling draught:	0.85m
- Displacement:	17000kg
- Installed power:	2x 30kW
- Max. speed:	7.0kn
- Cruise speed:	6.0kn
- Design Category:	Zona 6 Cat. D
- Passengers:	55pax
- Fresh water:	1x 125l
- Black/Grey water:	1x 500l

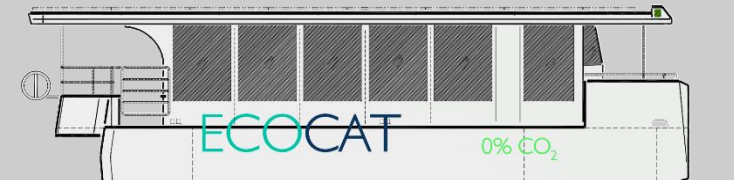

C2 | 050 – ECOCAT 2.0

The ECOCAT 2.0 is a catamaran built in naval aluminum and included within the BAHIA ZERO Project of the Bay of Santander.

This particular catamaran, has a length of 13.5m and a beam of 5.5m, with a total capacity for 55 passenger and 2 crew members.

The boat is 100% zero emissions thanks to its purely electric propulsion by two 30kW motors each, powered by two 100kW LiFePO4 batteries respectively. In addition, the top of the superstructure has a 40 high-efficiency SUNPOWER solar panels in order to increase the range and consumption under sailing condition.

The propulsion system is conventional and symmetrical on each hull. Each engine is directly coupled to the propulsion shaft equipped with a 17" propeller.

The boat has great maneuverability thanks to its propulsion system and its two proportional transverse propellers SE80PRO.

The passengers of the boat are distributed throughout the entire cabin, which occupies a large percentage of the boat length and practically the entire beam.

The distribution of the passengers allows free movement through two corridors that run along each of the sides of the boat in bow-stern direction.

These corridors besides to distribute the passage symmetrically, communicate the exterior fore and aft areas.

The boat is equipped by a complete WC, located in the aft area of the cabin with direct access from outside aft area.

The aft area, larger than the bow area, allows a pleasant stay aft of the boat with clear views to both sides and the stern of the boat.

The boat access is located in aft area through sliding doors on each side, integrated into the handrail.

The bow area allows the passage of passengers from one side to another. The anchoring system is located in this area.

The wheelhouse is located in centerline at the forward area of the cabin. This position allows a 360° vision thanks to the large windows of the cabin and its elevation position over the main deck of the boat.

The exterior styling of this first unit was designed by the cantabrian artist Okuda San Miguel, thus becoming his first work of art in motion.



NAVAL ARCHITECTURE
MARINE ENGINEERING

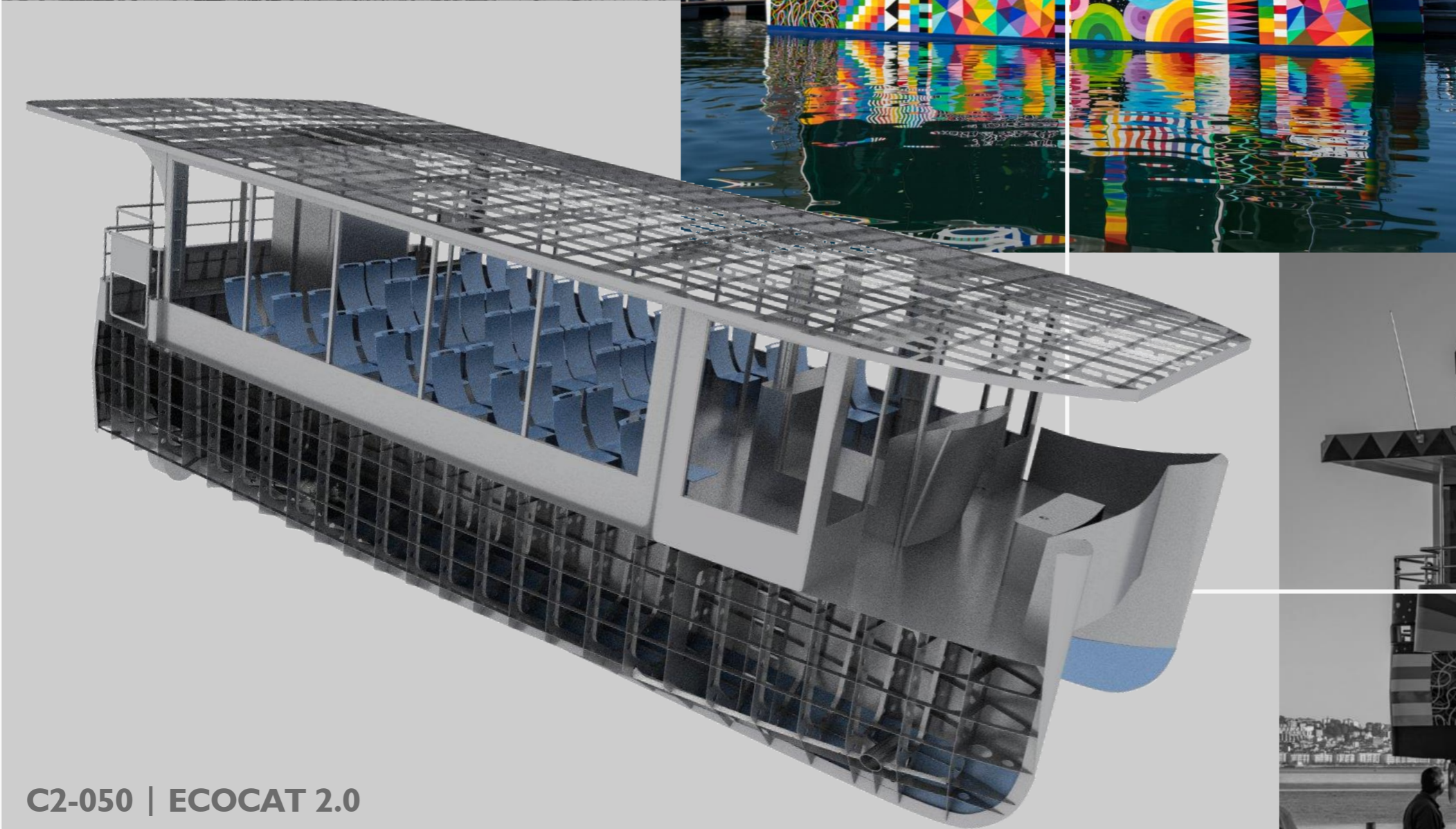

C2-050 | ECOCAT 2.0

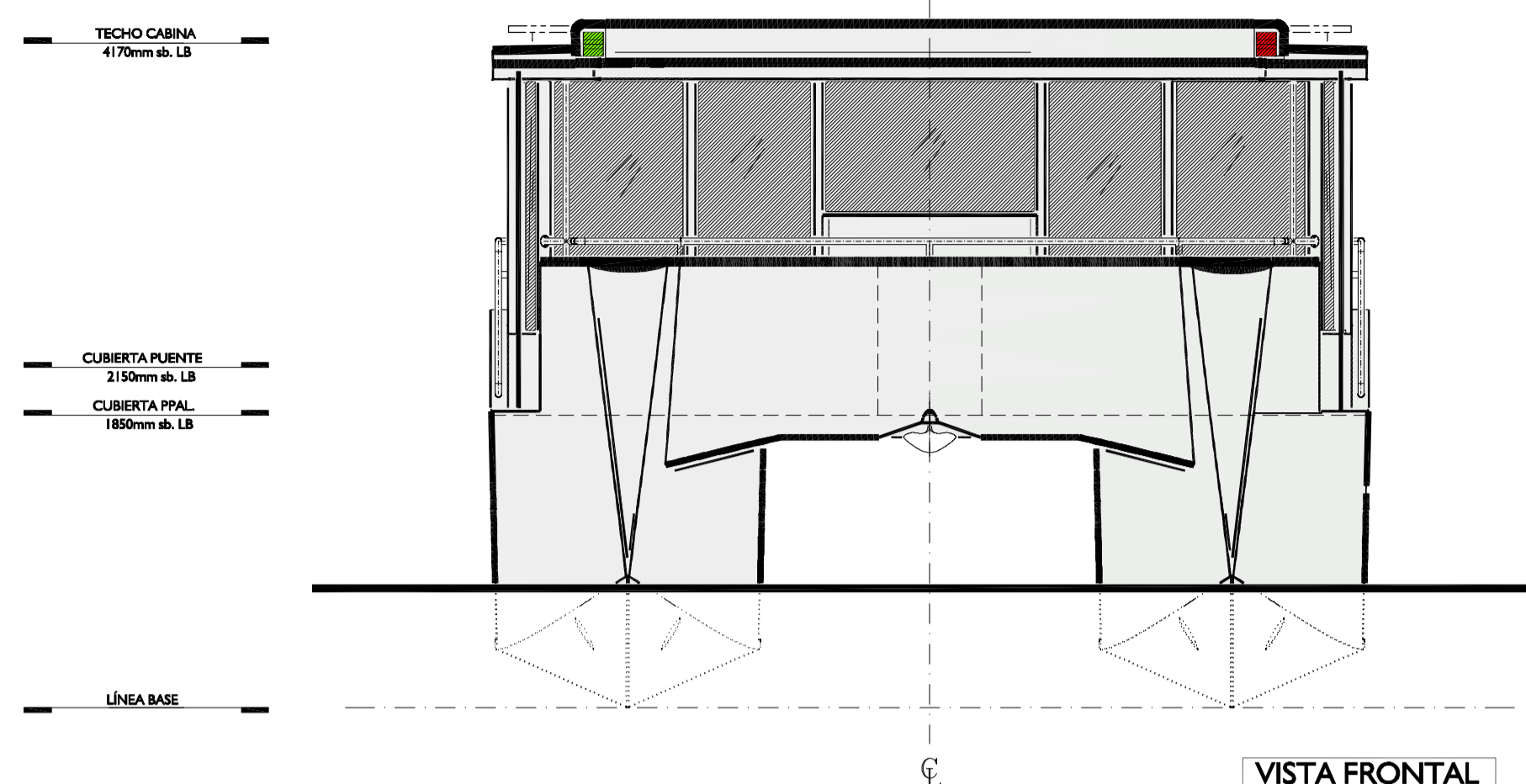
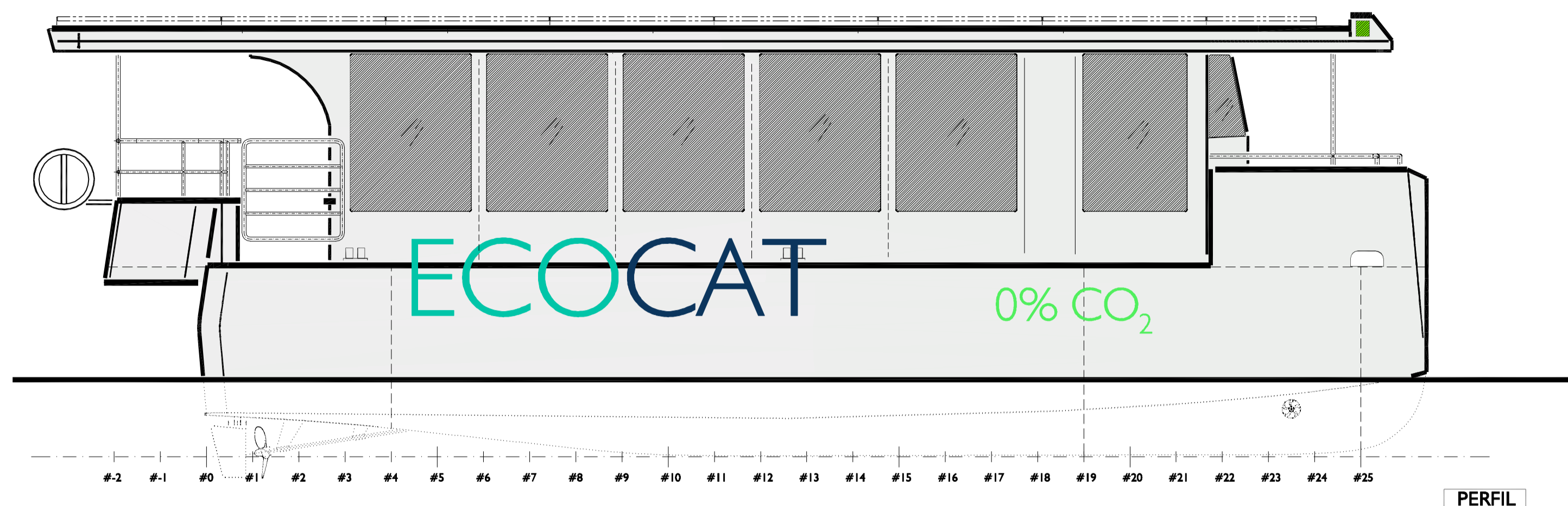

NOTA LEGAL

- 1 | El presente documento / plano es propiedad de C2 | NAVAL ARCHITECTURE & MARINE ENGINEERING (en adelante, C2), su copia, uso para construcción y/o divulgación a terceras partes no está permitida sin autorización expresa.
- 2 | El Astillero deberá verificar el contenido del mismo y notificará a C2 en caso de duda y/o posible discrepancia antes de su construcción.
- 3 | Cualquier modificación sin autorización expresa por parte de C2 será bajo responsabilidad del Astillero.
- 4 | Los pagos por el uso del presente documento / plano y toda la información perteneciente a este Proyecto, es considerada por "Licencia de Uso" para una unidad, salvo documento expreso.
- 5 | Ninguna construcción adicional deberá iniciarse sin los pagos correspondientes y sin consentimiento por parte de C2.

CARACTERÍSTICAS PRINCIPALES

Eslora reglamentaria	11.90m
Manga	5.50m
Altura	4.20m
Calado de diseño	0.75m
Calado de escantillonado	0.85m
Desplazamiento (Td)	17000kg
Categoría de diseño (CE)	Zone 6 Cat. D
Potencia máxima	2x 30kW
Pasajeros	60 pax
Tripulación	2 pax
Velocidad máx.	7.0kn
Velocidad de crucero	6.0kn @ 80% MCR
Agua dulce	1x 215L
Aguas grises / negras	1x 500L

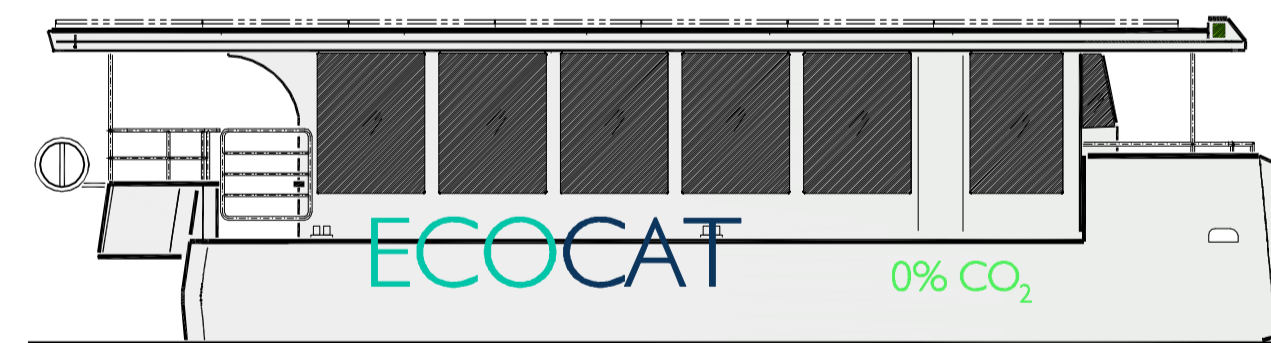
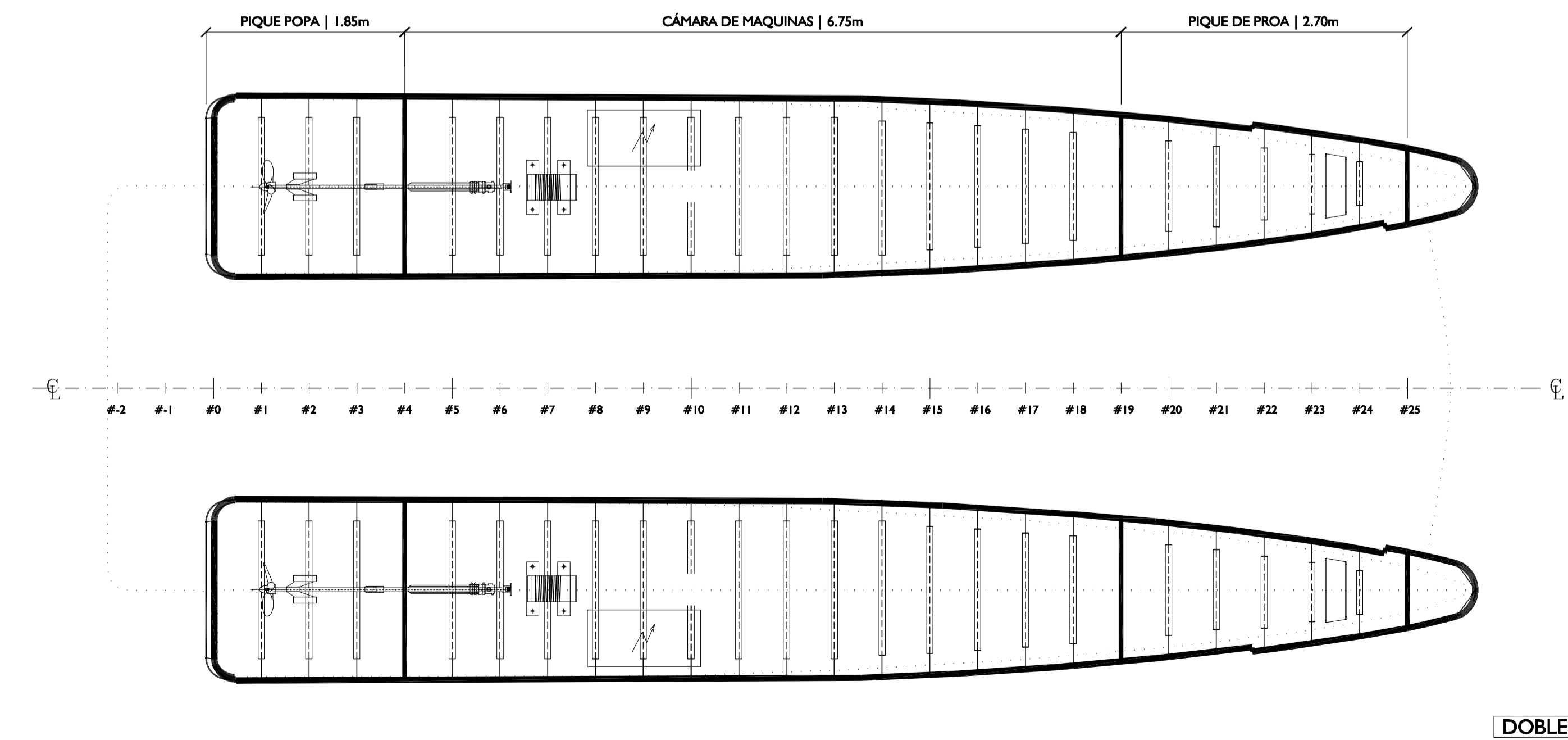
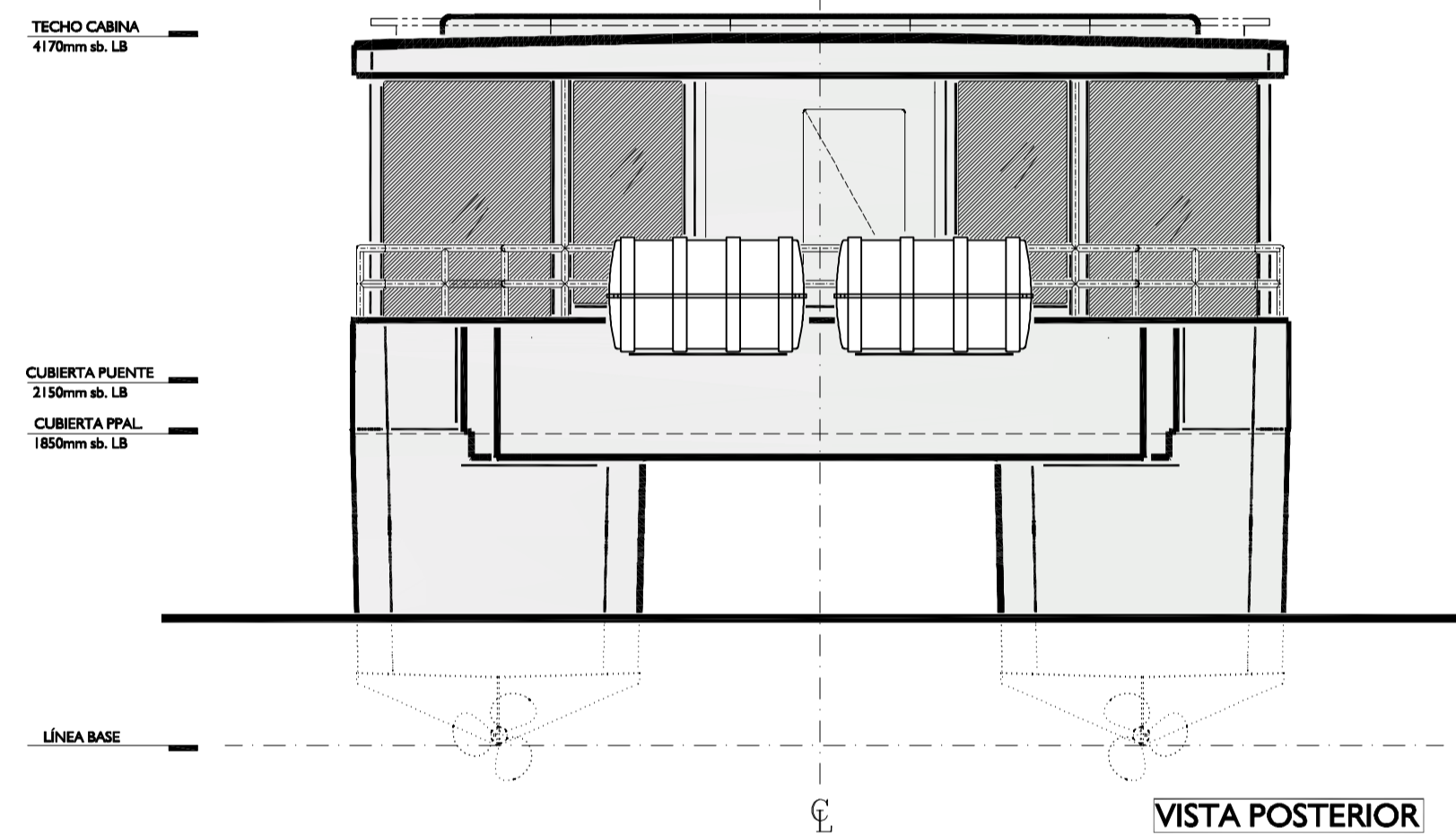
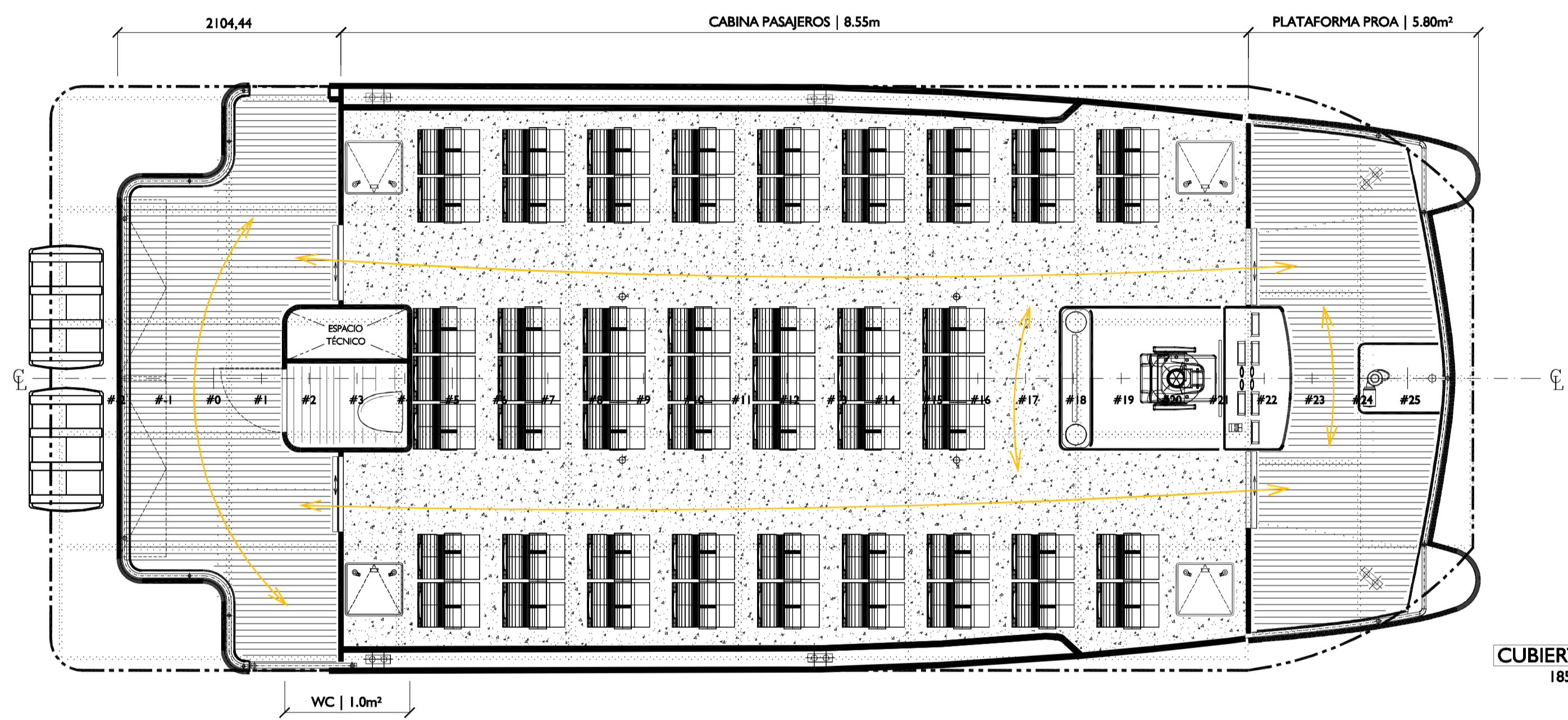

Rev.	Date	Made by	Date	Approved by	Description
05	20210602	MCC	20210602	MCC	Plano actualizado según cambios Astillero
04	20200917	ARA	20200917	MCC	Plano actualizado
03	20200726	ARA	20200726	MCC	Plano actualizado
02	20200616	MCC	20200616	MCC	Actualización según comentarios Astillero
01	20200614	MCC	20200614	MCC	Actualización según comentarios Astillero

Project | **050 ECOCAT 2.0**

Reference | **020 GENERAL ARRANGEMENT**

Scale | 1:40 | Format | A1 | Page | 1 | N. of Pages | 1

Made by | MCC | Date | 20200515 | Revised by | MCC | Date | 20200515

C2 | NAVAL ARCHITECTURE
MARINE ENGINEERING

www.C2-na.com | info@C2-na.com | +34-912-877-790

This drawing is the property of C2 | NAVAL ARCHITECTURE & MARINE ENGINEERING (hereinafter, C2). It should not be reproduced or reproduced for any construction or shared with third Parties without a written authorisation. Builder should check the content of this drawing and advise the C2 in case of any discrepancies prior to any construction. All modifications done by Builders without specific written authorisation are carried out under their exclusive responsibility.

Este plano es propiedad de C2 | NAVAL ARCHITECTURE & MARINE ENGINEERING (en adelante, C2). Su contenido no debe ser reproducido, adaptado a una nueva construcción ni compartido con terceras Partes sin autorización escrita. El Constructor deberá comprobar el contenido del presente documento y avisar a C2 en caso de discrepancia. Toda modificación realizada por el Constructor sin autorización expresa, será considerado bajo su responsabilidad.